



INSTRUCTION MANUAL

S2860, REV B

Site Lamp with Tripod AC Powered

LED-612



CE
RoHS
IP65

Powerful 2x30 SMD easy set up tower light for professional users on construction sites, workshops etc.

Light Output

High quality output of 4200 lumen for maximum coverage of workspace

Cool Light

Finned design reduces heating up of light

Sturdy Construction

- a. **IP 65 Rated**
Protected against dust and effects of pressure jets from any direction
- b. Corrosion resistant aluminium die cast housing in premium powder coated finish
- c. Telescopic stand can be extended from 0.8m - 1.72m (31 - 67 inch) to light overhead work or minimise shadows when casting light downwards
- d. Complete with 4m (13') long power cord

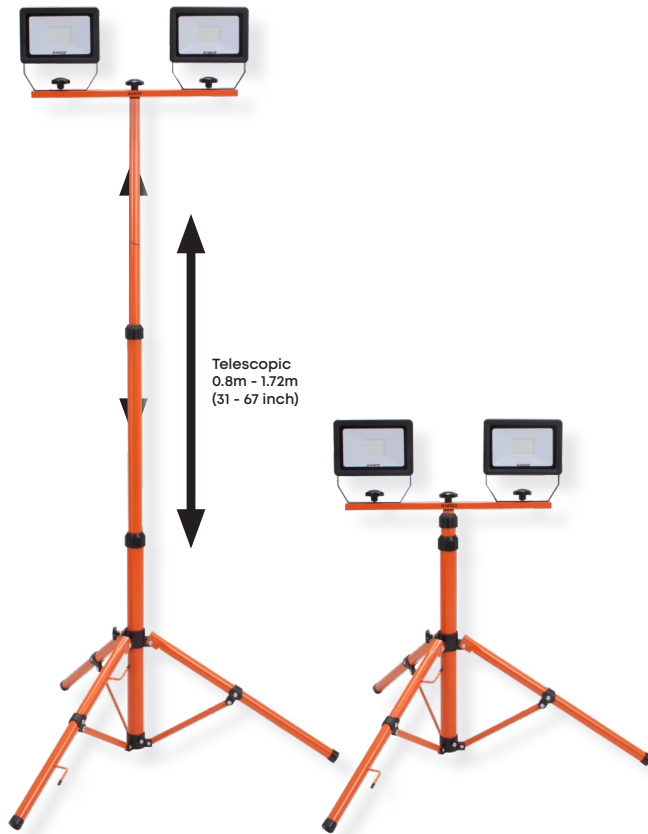

POWER SOURCE



220V AC, 50Hz
110 V AC, 60Hz

CAT NR.	PLUG TYPE	SIZE	
		(INCH)	(MM)
LED/612/US	US Pin	37 x 68-3/32 x 37	940 x 1730 x 940
LED/612/EU	EU Pin	37 x 68-3/32 x 37	940 x 1730 x 940

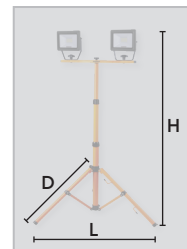



PACKAGING CONTENT

DESCRIPTION	QUANTITY
Light	1
Tripod Stand	1
Easy Connect Wire	1

NOMENCLATURE

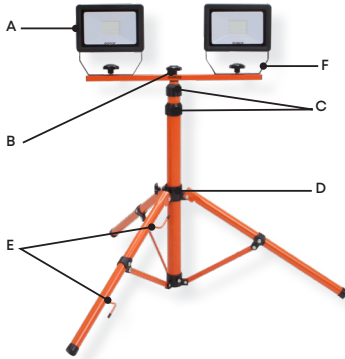

A	Luminous panel
B	Centre screw knob
C	Twist locks
D	Leg hinges
E	Cable hooks
F	Mounting bracket

SAFETY INFORMATION

- Please read the instructions carefully to ensure that the installation is done in the correct manner. In addition, this manual should be properly kept for future reference.
- This site lamp must be earthed.
- Always secure wires in plug terminals carefully. Make sure the cable is firmly located in the cord grip.
- Never connect the green & yellow wire to any terminal other than one marked with the earth symbol.
- Regularly inspect all electrical connections and wiring for damage. Any faults should be immediately rectified before further use of this site lamp.
- In use, ensure all wiring and extension cables are kept clear of any cutting tools, sharp objects and any other potential hazard such as wet floors, chemicals, solvents etc.

Note: If your main wiring differs in any way, consult a qualified electrician. Always ensure that the mains supply voltage is correct.

- Always replace the fuse with one of an identical rating.
- The lighting direction can not be adjusted to downward direction.
- Don't touch the hot surface by hand during adjustment and normal operation because of high temperature.
- Don't stand very close to the light while it is switched on.
- Don't look at the bulbs directly with naked eyes.
- Don't use the item without glasses and grills replace any cracked protective shield.
- The bulbs can't exceed the rated power.
- The distance between the item and any object must be more than 1m.

INSTALLATION (Refer "NOMENCLATURE")

Wire installation

1. Unscrew the junction box cover and remove diffuser and rubber seal.
2. Put your mains cable into the junction box ensure that the plastic stud is sufficiently tight.
3. Connect the mains wire.
4. Replace the junction cover, take care not to lose the rubber gasket on the cover.

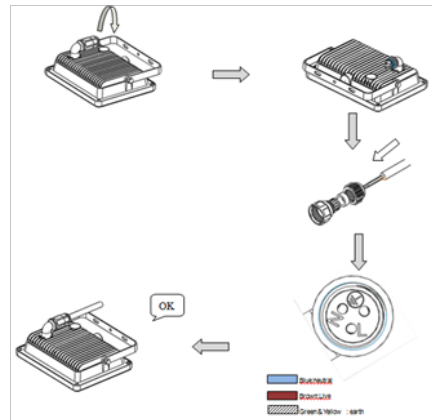

Light Installation

1. The tripod stand is supplied assembled, to attach this site lamp you must first erect the stand.
2. To open the legs push the spring pin upwards and, at the same time, pivot the leg down. Release the spring pin whilst pivoting the leg and the pin will locate into one slot.
3. To alter the stand height twist the locks(C) anti-clockwise to release, slide the tubes to desired height and tighten the twist locks clockwise.





4. Attach this site lamp to the crossbar(F) by securing with the screw knob nut & bolt assemblies(F) through the centre hole on the brackets of each this site lamp. Unscrew the center knob(F) for safe storage of the mains cable when not in use.
5. To adjust this site lamp angle, loosen the screws located on either side of the bracket, until the desired angle is achieved, then re-tighten.
6. Check this site lamp is secure and that the stand is stable and has a firm footing. Ensure cable is not catching on any sharp object and that the mains plug connection is adequately protected against rain or moisture. Your site lamp is now ready for use.

DISPOSAL

The components or the used products must be given to companies that specialize in the disposal and recycling of industrial waste.





Groz Engineering Tools Pvt. Ltd.
Groz Net Industries

Village Kherki Daula, National Highway-8,
Gurugram-122004, Haryana, INDIA

Tel +91.124.282.7700

E-Mail info@groz-tools.com

Url www.groz-tools.com

The GROZ name, GROZ logo and the  mark are trademarks of GROZ Engineering Tools Pvt. Ltd., India

