



## Site Lamp AC Powered

LED-602



CE  
RoHS  
IP65

Powerful 28 SMD portable light for use on construction sites, workshop etc.

### Light Output

High quality output of 2100 lumen for maximum coverage of workspace

### Cool Light

Finned design reduces heating up of light

### Sturdy Construction

- a. **IP 65 Rated**  
Protected against dust and effects of pressure jets from any direction
- b. Corrosion resistant aluminium die-cast housing in premium powder coated finish
- c. High impact polycarbonate lens to withstand harsh job site conditions
- d. Complete with 4m (13') long power cord

### Portable

Free standing steel stand with cushion grip and adjustable bracket makes it convenient to move light as required in the workspace

Easy Set-up and instant illumination



### POWER SOURCE

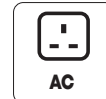

220V AC, 50Hz  
110 V AC, 60Hz

CAT NR.	PLUG TYPE	SIZE	
		(INCH)	(MM)
LED/602/US	US Pin	9-1/16 × 14-3/16 × 8	230 × 360 × 205
LED/602/EU	EU Pin	9-1/16 × 14-3/16 × 8	230 × 360 × 205

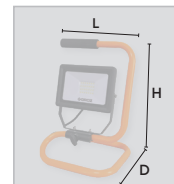



### PACKAGING CONTENT

DESCRIPTION	QUANTITY
Light	1
S Stand	1
Easy Connect Wire	1

### NOMENCLATURE

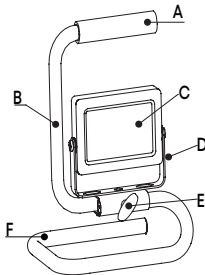

A	Padded Carry Handle
B	Portable tube
C	Luminous panel
D	Lamp body fixing frame
E	Angle Adjustment Screw Knob
F	S Stand

### SAFETY INFORMATION

- Please read the instructions carefully to ensure that the installation is done in the correct manner. In addition, this manual should be properly kept for future reference.
- This site lamp must be earthed.
- Always secure wires in plug terminals carefully. Make sure the cable is firmly located in the cord grip.
- Never connect the green & yellow wire to any terminal other than one marked with the earth symbol.
- Regularly inspect all electrical connections and wiring for damage. Any faults should be immediately rectified before further use of this site lamp.
- In use, ensure all wiring and extension cables are kept clear of any cutting tools, sharp objects and any other potential hazard such as wet floors, chemicals, solvents etc.

**Note:** If your main wiring differs in any way, consult a qualified electrician. Always ensure that the mains supply voltage is correct.

- Always replace the fuse with one of an identical rating.
- The lighting direction can not be adjusted to downward direction.

- Don't touch the hot surface by hand during adjustment and normal operation because of high temperature.
- Don't stand very close to the light while it is switched on.
- Don't look at the bulbs directly with naked eyes.
- Don't use the item without glasses and grills replace any cracked protective shield.
- The bulbs can't exceed the rated power. The distance between the item and any object must be more than 1m.

### INSTALLATION

(Refer "NOMENCLATURE")

#### Wire installation

1. Unscrew the junction box cover and remove diffuser and rubber seal.
2. Put your mains cable into the junction box through the plastic stud and rubber gasket ensure that the plastic stud is sufficiently tight.
3. Connect the mains wire.
4. Replace the junction cover, take care not to lose the rubber gasket on the cover.

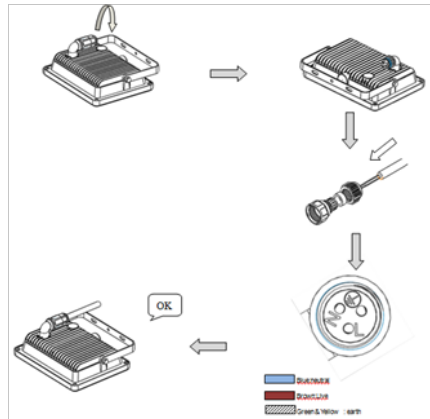

#### Light Installation

1. Slide the stand(E) into this site lamp bracket (F).
2. Align the holes in the bracket and the stand. Insert and tighten angle adjustment screw knob (D).
3. To alter the angle of this site lamp, simply loosen the angle adjustment screw knob(D), pivot this site lamp until the desired angle is achieved and re-tighten knob (D).
4. Check this site lamp are secure and that the stand is stable and has a firm footing.

#### DISPOSAL

The components or the used products must be given to companies that specialize in the disposal and recycling of industrial waste.





Area with horizontal dashed lines for text entry.

**NOTE**





---

**Groz Engineering Tools Pvt. Ltd.**  
**Groz Net Industries**

Village Kherki Daula, National Highway-8,  
Gurugram-122004, Haryana, INDIA

**Tel** +91.124.282.7700

**E-Mail** [info@groz-tools.com](mailto:info@groz-tools.com)

**Url** [www.groz-tools.com](http://www.groz-tools.com)

The GROZ name, GROZ logo and the  mark are trademarks of GROZ Engineering Tools Pvt. Ltd., India

